

Content

411421 Silver Peel

- 01. Important Safeguards 3
- 02. Silver Peel Unit 4
- 03. Connecting the handpiece 4
- 04. Contraindications of Exfoliation 5
- 05. Tips Cleaning and Disinfection 6
- 06. Protocol 6
 - 6.1 Exfoliation Protocol 6
 - 6.2 General Treatment Protocol 7
 - 6.3 Specific treatment protocol 7
 - 6.4 Procedure Chart 8
 - 6.5 Potential Side Effects 9
- 07. Consent Form 10
- 08. Client Instructions Sheet 11
- 09. Important 12
- 10. Specifications 12
- 11. List of Symbols 13

SILVER



Crystal Free Microdermabrasion

Thank you for purchasing the Silver Peel exfoliation system. We realize that there are many Crystal free systems available and we are confident that choosing a Silhouet-Tone product, crafted and manufactured in North America, will reward you with many years of trouble free operation and the excellent results the industry has come to expect from Silhouet-Tone products.

All rights reserved. No part of this work covered by the copyright hereon may be reproduced or used in any form or by any means— graphic, electronic, or mechanical, including photocopying, recording, taping, or information storage and retrieval systems— without permission of the company.
© Silhouet-Tone Corporation 2020

01. Important Safeguards

Read the following instructions before using this unit.

1. This device is intended to be used only for purposes that are approved and described in this original manual. Use only with instructions recommended by the manufacturer.
2. Never perform a procedure on inappropriate or sensitive areas.
3. Prior to each use of the system, inspect all cables and attachments for any damage, excessive wear, or crimping that could affect system performance or safe operation. Never use the system if any damage is visible.
4. Do not use this device if the power cord has been damaged, if it is not working / operating correctly or damaged. If the supply cord is damaged, it must be replaced by a special cord or assembly available from the manufacturer or its service agent.
5. Keep power cord away from heat source.
6. **WARNING:** To avoid the risk of electric shock, this equipment must only be connected to a supply main with protective earth.
7. **WARNING:** Caution should be exercised to avoid spilling any liquids on the unit.
8. Never pull the power cord to disconnect the equipment from the mains. Always do so by firmly grasping and pulling the connector. Always allow enough space between the equipment and the mains for easy disconnect or plug in access.
9. This device should only be operated by an appropriately trained and certified personnel possessing knowledge of the skin physiology and only in a professional setting. If you have any questions regarding the operation of this unit, contact Silhouet-Tone or your local distributor. This appliance is designed to be used only by trained professionals in commercial areas.
10. Grounding instructions:
This unit must be properly grounded. In the event of short-circuit, the power cord's ground prong will reduce the risk of electric shock by providing an escape route for the current.
The power cord is equipped with a grounding wire and three-pronged plug. The power cord must be plugged into a properly installed three-pronged grounded outlet.
DANGER: THE IMPROPER USE OF A GROUNDING PLUG MAY CAUSE ELECTRIC SHOCK.
WARNING: DISCONNECT THE APPLIANCE FROM ITS POWER SOURCE DURING SERVICE AND WHEN REPLACING PARTS.
11. The power cord should be routed so that they are less likely to be walked on or pinched by items placed on or against them. Pay particular attention to cords at plugs, convenience receptacles, and the point where they exit the unit.
12. Do not use any adaptors with this unit. Do not modify the plug if it does not fit the outlet. Have an electrician install a suitable outlet.
13. Do not overload wall outlets and extension cord; this can lead to an increase risk of fire or electric shock.
14. All maintenance work must be done by SILHOUET-TONE or an authorized service representative. Do not attempt to service this unit yourself. Opening the unit may expose you to high voltage or other hazards, and will void your warranty. Always use Silhouet-Tone certified replacement parts and accessories.
15. To ensure continuous protection against fire, always replace the fuse with one of identical type and amperage, as approved by the manufacturer.
16. Never immerse the hand piece in any type of solution.
17. Slots and openings in the unit casing are for ventilation. They are there to ensure reliable operation and prevent overheating. These openings must not be blocked or covered. This unit should not be placed in a built-in installation unless proper ventilation is provided.
18. Do not use other accessories than those recommended by the manufacturer. Improper accessories can damage the unit's components and create blockages.
19. Do not use the unit near water for example: near a sink, wash bowl, hydro tub, steamer, wet table, swimming pool, autoclave, hot cabi.
20. Do not place the unit on an unstable cart, stand, tripod, bracket, or table. A fall could produce serious injury and serious damage to the unit. Use only with recommended base. Follow manufacturer's instructions for unit installation onto base. The combination should be moved carefully. Quick stops, excessive force, and uneven surfaces may cause damages to the unit.
21. This appliance is not intended for use by persons (including children) with reduced physical, sensory or mental capabilities, or lack of experience and knowledge, unless they have been given supervision or instruction concerning use of the appliance by a person responsible for their safety. Children should be supervised to ensure that they do not play with the appliance.
22. Do not service while in use.
23. Equipment and parts must be disposed of through institutional recycling facilities or electronic disposal facilities
24. **Warning:** The equipment must not be modified in any way.

Save these instructions!

02. Silver Peel Unit

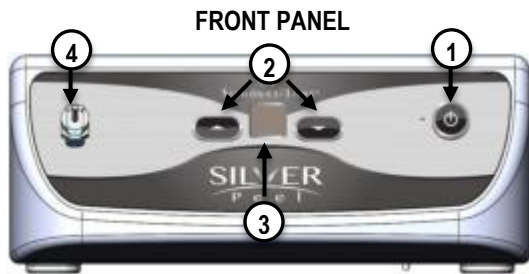

1. Procedure START / STOP key.
2. Intensity control (UP / DOWN).
3. Intensity display screen (00-10).
4. Hand piece connection outlet.

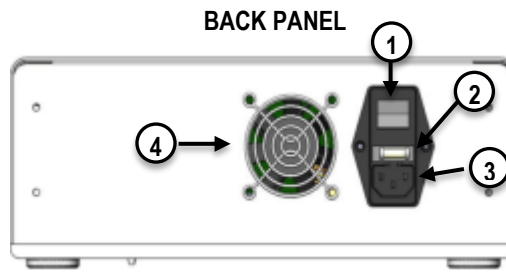

1. ON / OFF main switch.
2. Fuse box.
3. Power cord outlet.
4. Ventilation opening.

Starting the procedure:

- Connect the handpiece to Silver Peel unit (as per instructions below).
- Turn on the main power switch on the back of the unit. (The LED indicator on front panel will light up).
- Wait at least 10 seconds for unit to warm up.
- Press the "START / STOP" key (on the front panel).
- Adjust the abrasion / vacuum power with the intensity key (located on the front panel).
- The intensity will appear on your screen.

! Note: Ensure the central unit is POWERED OFF before connecting handpiece.

! WARNING:

- ✓ Always begin procedure at the lowest intensity setting.
- ✓ Always ensure that the filter is inserted into the hand piece before any procedure.

03. Connecting the handpiece

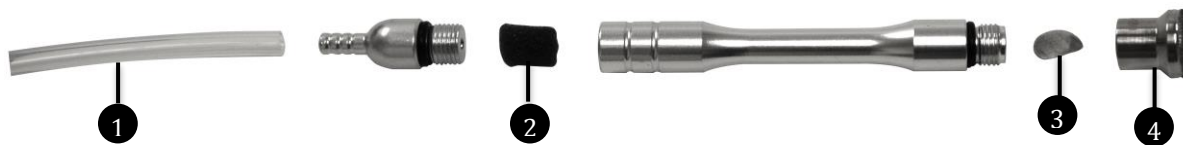

1. Insert the Diamond tip wand into the vacuum tube (#1) and connect tube to the unit.
2. Select the Diamond tip (#4), install filters (#2 and #3) and screw onto the wand.

Changing Diamond Tips filters

2 Filters are used, they provide 2 levels of protection. If the small flat filter is compromised, the larger black foam filter, will catch dirt and skin debris.

! IMPORTANT: If the filters are not regularly replaced, dead skin cells may enter in the system causing it to lose suction power.

When to replace filters:

1. The small mesh filter should be replaced **after each use.**

2. The larger cylinder foam filter should be replaced **after 6 abrasions**. The foam filter will catch dead cells to prevent clogging of your machine

04. Contraindications of Exfoliation

Reminder

- Refer client to physician for any medical treatments or doubts regarding skin conditions.
- Perform procedure **ONLY** on healthy skin, free of infections or inflammations (wounds, infected scars, acne, etc.).
- Do not abrade beauty spots or moles, bypass them without touching.

CONTRAINDICATIONS

- Allergy to stainless steel.
- Active local skin infection of all types (herpes simplex virus, flat warts, etc.).
- Active acne (with pustules).
- Users of Isotretinoin medication (Accutane, Roaccutane) must wait 1 year between medication interruption and beginning of exfoliation procedure.
- Vascular lesions (broken capillaries and rosacea).
- Uncontrolled diabetes.
- Eczema, dermatitis or any inflammatory skin condition.
- Skin Cancer.
- Blood thinner.
- Any medical condition that prohibits exfoliation.



WARNING:

- ✓ *BEFORE A PROCEDURE, INSPECT THE TIP for any excessively jagged or abnormally formed surfaces on the tip (anything that could cause a cut in the skin). **DO NOT USE THE TIP** if you notice any damage.*
- ✓ *Prior to procedure, always test the abrasion intensity on the inside of the client's forearm, where the skin is most sensitive. Wait for 5 minutes and if no reaction is observed (redness, rash, bumps, swelling or any other reaction on tested area) you can begin procedure. If any reaction appears, do not proceed, if necessary refer the client to a doctor.*
- ✓ *Extra care must be taken when working on mature or reactive skin.*
- ✓ *For first exfoliation, always use the fine tip at the lowest suction.*

Potential Side Effects

The majority of reactions (unless allergy to stainless steel presented) are related to procedure's intensity and user's manipulations.

Potential side effects:

- Mild erythema and increased sensitivity may be observed, but usually resolves within 24 hours.
- Petechial spots (small red-purple spots on the skin) may appear during or after the procedure. This indicates that settings are too strong so you need to reduce the intensity. Mature skin is particularly susceptible to this type of reaction but will usually resolves within 48 hours.
- Telangiectasia or other vascular conditions may be aggravated by skin exfoliation.
- Mild flaking may occur over 2 days.
- Post microdermabrasion hyperpigmentation effect can be avoided by avoiding sun exposure and using sun block.

05. Tips Cleaning and Disinfection

It is recommended that you clean the device daily. Soak a soft pad in non-corrosive cleansing liquid (70% isopropanol or ethanol, Sporidicin®, chlorhexidine, betadine or other) and gently wipe the surface area of the device.

Wipe down the device once again with a clean, dry pad or let it naturally air dry.

⚠ IMPORTANT: *In order to maintain the tip's durability it is recommended to follow the above indicated CLEANING PROCEDURE:*

1. BEFORE FIRST USE and immediately after each use, the metal tip should be cleaned for few minutes under running water, scrubbing with a fine polymer brush to remove any residues.
2. **Use** a very gentle disinfectant with a pH value of no less than 5 and no more than 7 and also containing anticorrosive agents to avoid potential corrosion of the tip. To ensure **MAXIMUM GUARDING** against potential discoloration of the identifying rings of your abrasion tips, please **AVOID any alkaline or acidic products**.
3. Dry thoroughly the tips after cleaning.
4. Before each treatment clean the outside of the vacuum tube with a bactericidal wipe (for example Preempt® wipes)

⚠ ATTENTION!

- ✓ *We recommend that you not use the handpiece if you are unable to properly clean and disinfect tips as per recommendations.*
- ✓ *NEVER immerse tips in any acidic or alkaline solutions to avoid potential tip corrosion.*
- ✓ *ALWAYS keep tips DRY in order to preserve their properties.*
- ✓ *ALWAYS CLEAN TIPS FOLLOWING THE PROCEDURE INDICATED ABOVE.*
- ✓ *ALWAYS use a fine polymer brush to not damage the tips.*
- ✓ *NEVER hit, scratch or damage the tips in order to maintain their abrasive properties.*

NOTE: It is recommended to replace tips if you observe any reduction in their abrasive properties. For optimal use of your system, IT IS RECOMMENDED to replace your tips yearly.

06. Protocol

6.1 Exfoliation Protocol

Refer to Chapter 5 for **cleaning instructions** (same procedure to apply).

Proper cleaning of the Diamond tips is essential for maintaining optimum effectiveness.

System set-up

1. Insert the Diamond tip wand into the vacuum tube and connect the tube to the unit.
2. Select the Diamond tip, install filters and screw onto the wand (see Chapter 3 for filter installation).
3. Adjust vacuum pressure.
4. Test the settings on the client's hand or arm. Excessive pressure will cause redness or bleeding. Treatment must be comfortable never painful.

Skin Evaluation: should include a review of your client's skin history and prior experience with skin treatments, a quick examination for any active skin infection(s) or non-healing skin lesion(s) and an overview of your client's expectations.

The entire microdermabrasion treatment last approximately 20 minutes.

Selection of Treatment Tips

✓ **“Diamond Tips” are selected according to blemish size.**



Diamond Tips:

- Face (1 fine, 1 medium, 1 coarse)
- 1 Eye, 1 Nose
- Body (2 medium, 2 large)

9 sizes available with different degree of coarseness.

Smaller tips are used during Phase 2 of Silver Peel treatments to perform precision abrasion over imperfections.

Select the size and coarseness of the tip. The aggressiveness of the desired treatment will determine grit size while diameter is relative to treatment area size. The Diamond tip heads range in coarseness from fine (D-250 grits) to very coarse (D-100 grits).

Treatment Zones

Divide the face into 3 zones (see next **section 6.5**)

- a) Work on both cheeks and jaw line
- b) Finish with the neck
- c) Change to a smaller diamond tip to work on imperfections

Treatment Phases

The treatment is performed in 3 phases

- Phase 1-** General abrasion
- Phase 2-** Working on specific problem areas and imperfections
- Phase 3-** General rapid abrasion to even out complexion

Treatment movements (see next **section 6.4**)

4 specific movements are used during the abrasion process:

- a) Linear technique for general abrasion,
- b) Eraser type motion for skin imperfections,
- c) Square pattern when working on large areas, such as cheeks afflicted with acne scars or enlarged pores,
- d) Circular sweep for small minor imperfections.

6.2 General Treatment Protocol

Client preparation

- Clean the skin by applying a foaming gel. Using your fingertips work into a lather and rinse thoroughly with warm towels or wet gauze.
- Choose the appropriate abrasion tip.
- **Test the intensity on the client forearm.**

Treatment

- Use smaller diamond Tips to work on individual imperfections.
- Remove any dead cells and debris with a gentle soothing lotion.
- Apply a treatment product suitable to your client' needs.
- Apply a treatment mask according to skin problem and skin reaction.
- Apply a moisturizer selected according to skin type.
- Apply a sun screen SPF 15-30.

6.3 Specific treatment protocol

Skin imperfections treatment

- Change to a medium diamond tip (D-250 for fine skin, D-200 for medium and D-100 for thicker skin) to work on individual imperfections.
- Use a square pattern movement on enlarged pores

- Use a gentle soothing lotion to remove any dead cells and debris
- Apply a purifying treatment product suitable to your client's needs.
- Apply a purifying treatment mask suitable for your client's skin.
- Apply an oil free moisturizer selected according to skin type.
- Apply a sun screen SPF 15-30

6.4 Procedure Chart

Divide the face into 3 Zones

- Zone 1: Forehead (below the hairline and above the eyebrows).
- Zone 2: Mid face area (nose, cheeks, jaw, upper and lower lip, chin).
- Zone 3: Neck and neckline.

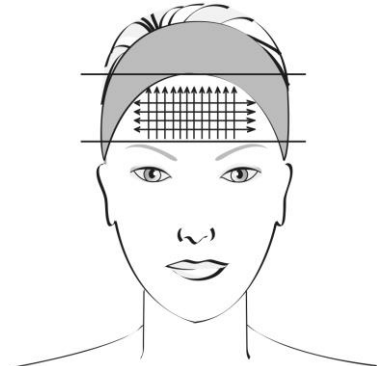

Zone 1: Forehead

- Be conservative during the first procedure using a magnifying lamp to reassess the abrasion. Use a **fine or medium tip** and **vacuum intensity setting at lowest value**.
- Start by proceeding from the brows to the hairline vertically. Go over area repeatedly to desired depth of exfoliation. Repeat the pattern horizontally.

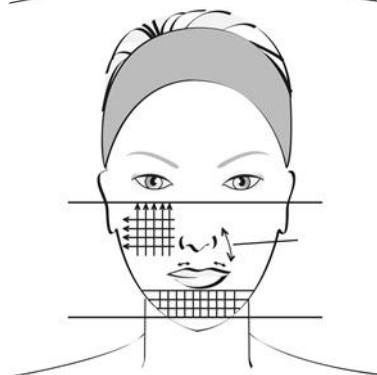

Zone 2: Mid-face area

Use a fine or medium tip and vacuum intensity setting at lowest value.

Take additional steps to keep the skin taut and avoid areas around the eye.

- Begin on the side of the face with vertical passes and cross with horizontal passes. Go over areas repeatedly to achieve desired depth of exfoliation.
- Move down on the nose following the contours, and around the creases.
- Work the upper lip area moving horizontally from the corner of the mouth over to encompass the smile lines. Make sure the skin is kept taut.
- Then pass to the chin and lower jaw areas with vertical and horizontal passes.
- **Never pass on the lip's border and colored part.**

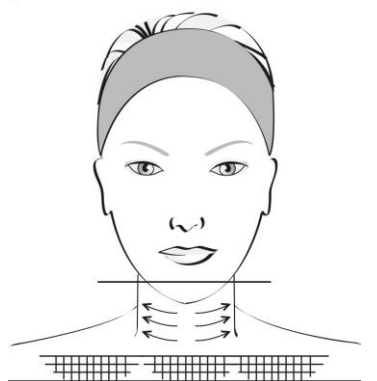

Zone 3: Neck and neckline

Use the fine or medium tip with reduced vacuum intensity when working on the neck to avoid streaking. Always make sure the skin is held taut.

- Most clients require only horizontal passes on the neck area. Passes are performed from center outward.
- The 'Décolleté' will require vertical and horizontal passes using the fine or medium tip with lower vacuum setting similar to the neck.

After procedure:

- Rinse treated area with soothing lotion and cool compresses.
- Apply appropriate calming or cooling mask, leave on for 5-10 min.
- Remove product with cool towel.
- Apply moisturizer and sun block.

6.5 Potential Side Effects

During the 3rd or the 4th day following a session, skin may desquamate if the intensity used during the procedure was too high.

Swelling and redness:

- May be due to aggressive or low pH acid products used after the procedure.
- Low pH products containing Retinol-A, AHAs, enzymes or essential oils may also cause skin irritation when used after skin abrasion. Skin will therefore be over treated and may react causing swelling, heating or redness.
- Following over aggressive procedures, some skins may also show slight swelling. This is not a problem. Apply calming and hydrating products.
- Petechial rash may appear during or after the procedure. This usually indicates that the vacuum setting is too strong. Working with low intensity on mature skin will avoid the problem.

Allergic skin reaction:

- An allergic reaction to a cosmetic product will cause an intense heat sensation, intense redness or itching during product application. You must remove the product immediately and use a cooling mask.

Pigmentation problems:

- Be extra careful with skin that is prone to hyper pigmentation. Avoid the sun and tanning beds and use sun block at all times (SPF 15 or SPF 30).

Very Important:

- ✓ *During consultation, we recommend giving to each client a "Client Instructions Sheet".*
- ✓ *It is recommended to perform consultation and exfoliation sessions at 2 to 3 weeks intervals.*
- ✓ *Most skin reactions can be avoided by providing the "Client Instructions Sheet", prior to first procedure.*

07 . Consent Form

Microdermabrasion is a widely used procedure performed by licensed estheticians, involving the exfoliation of the outer layers of the skin. This is accomplished by a stainless steel tip rotating gently on the skin. The procedure is gentle and respects the integrity of the skin, with literally no recovery time for most people, though there are a few areas of the face where the procedure may feel slightly uncomfortable. Microdermabrasion has been successful in temporarily improving the appearance of fine lines, large pores, and cleansing the skin. This may take several sessions (average six) the number of which varies with each individual. _____

Even is the stainless steel tip is not allergenic, possibility of allergic reaction might happen. To test this, a patch test will be always performed prior to microdermabrasion. _____

After exfoliation, some reactions as swelling, redness or petechial spots (red to purple skin spots) might appear, due to individual skin reactions and sensibility of each person. _____

During cold sore, herpes simplex, inflammatory or acne eruptions, it is necessary to discontinue sessions to avoid spreading the condition. The procedure should be deferred until the skin is perfectly healed. _____

Further to microdermabrasion it is necessary to use neutral pH moisturizers and to wear a protective sunscreen no less than SPF 15 but no more than SPF 35. Failure to follow these recommendations and wear sunscreen can result in sunburn on your face, and skin damage could occur. _____

I do not present any of the Contraindications:
_____ (initials)

If yes, Microdermabrasion procedures cannot be performed _____

While many satisfying results are achieved after six (6) session series, there is no guarantee that the desired effects will be achieved within that delay. Your own body response is a major factor in the result process. _____

I have read the preceding explanations and understand the potential risks and benefits of microdermabrasion. All my questions have been answered in a satisfying manner and I have received a copy of the "Client Instructions" sheet and agree to follow them and to protect my skin against the sun at all time.

Client Name: _____ Signature : _____

Telephone Number: _____ Date : _____

Witness Name: _____ Signature: _____

08. Client Instructions Sheet

Prior to peel

- Discontinue use of: retinoids (Retin-A, Renova), AHAs (glycolic or other acids) or any other chemical peels at least one week prior to peel.
- Postpone procedure in case of active herpes (cold sore) outbreak or if you plan exposure to strong sunlight (such as sailing, skiing).

Immediately after peel

Moisturizer and sunscreen will be applied before leaving facility.

- Your skin will feel like a mild wind burn or sunburn. Maintain hydration, both topically and internally (drink plenty of water).
- Moisturize and reapply sunscreen several times throughout the day, as needed.
- Avoid direct sunlight as you now have fresh, newly exposed skin.
- Avoid whirlpool or swimming in a chlorinated pool for 48 hours following the day of the exfoliation.
- Avoid waxing treated areas for two (2) weeks after procedure.

After peel

- Maintain hydration of skin and increase fluid intake.
- Continue to use sunscreen at least SPF 15 up to SPF 35. *(The use of a sunscreen above SPF35 is not recommended as it can induce irritation following skin exfoliation).* Be extra careful if skin is prone to hyperpigmentation and use sunscreens at all times.
- Exposure to UV rays must be avoided during 7days after exfoliation.
- Avoid retinoids, glycolic acids or any chemical peels and for three (3) weeks following procedure.

09. Important

This system makes no medical claims. This procedure is not used in any mean of treating any medical pathological condition. The system is intended and should be used by licensed estheticians for esthetic purposes only.

Terms microdermabrasion, abrasion, exfoliation or peeling terms describe the same procedure: the esthetic exfoliation.

The masculine generic refers to both the masculine and feminine genders and is used for conciseness purposes only.

- If you have questions regarding the operation of this system, call Silhouet-Tone or your local distributor.
- Silhouet-Tone is not responsible for damage or accidents caused by the incorrect or unprofessional usage of the system.

Silver Peel system includes:

- 420975 | 1 instructions manual
- 416681 | 1 kit diamond tip*

10. Specifications

Universal Power Supply :	120 - 230 VAC, 50/60Hz, 0.5-1.0 A
Fuse Type :	1A-250V-SB-5x20mm-239 series Breaking capacity : 35 A @ 250 Vac
Operating Mode:	Continuous
Current Consumption:	1.0-0.5 A
Protection Class:	1 (Grounded)
Dermabrasion - Operating Vacuum Range (static):	30 to 802 kPa
Open Flow	Minimum 18 Lpm
Unit Dimensions:	Width : 12.0 in (305 mm) Height : 6.3 in (160 mm) Depth : 11.5 in (292 mm)
Unit Weight:	11.5 lbs (5.2 kg)
Construction:	Epoxy Coated Metal Housing Injection Molded Face
Electronics:	Microprocessor Controlled
Safety Filter :	Long-Life Replaceable Cartridge and Filter
Ambient Operating Temperature	+10° C to + 40° C
Ambient Operating Humidity:	30 % to 75 % RH
Ambient Operating Atmospheric Pressure:	70.0 kPa to 106.0 kPa
Ambient Storage Temperature	-15° C to + 50° C
Ambient Storage Humidity:	0 % to 80 % RH
Ambient Storage Atmospheric Pressure:	70.0 kPa to 106.0 kPa

SILHOUET-TONE RESERVES THE RIGHT TO CHANGE THESE SPECIFICATIONS WITHOUT NOTICE.

11. List of Symbols



Potential hazards



Read and understand owner's manual before operating this product



Product's article number



Manufacturer



Waste Electrical and Electronic Equipment (WEEE)



Type B



TÜV Certified



Silhouet-Tone

2185 Michelin
Laval, Québec
H7L 5B8 Canada
Tel.: 1-450-687-9456
Fax: 1-450-687-5155

All rights reserved. No part of this work covered by the copyright hereon may be reproduced or used in any form or by any means— graphic, electronic, or mechanical, including photocopying, recording, taping, or information storage and retrieval systems— without permission of the company.

© Silhouet-Tone Corporation 2020