

VORTEX-PEEL



VORTEX-PEEL



INSTRUCTION
MANUAL



SILHOUET-TONE®

Content

Vortex-Peel	3
01. First Use Instructions	4
02. Important Safeguards	5
03. Unit Description	7
3.1 Control Panel	7
3.2 Handpiece Installation	8
3.3 Corundum Crystal	9
3.4 Unit Preparation before Microdermabrasion	11
3.5 Filters Replacement	12
04. Microdermabrasion Contraindications	13
05. Client Record Card	14
06. Microdermabrasion Series Protocol	15
07. Client Recommendations Prior to Microdermabrasion Session	16
08. Room and Client Preparation	17
09. Procedure Techniques	19
10. Suggested Unit Settings	20
11. Microdermabrasion Procedure Chart	21
12. Microdermabrasion Procedure	22
13. Combining Microdermabrasion with Facial Procedures	24
14. Other Applications of Microdermabrasion	25
15. General Client Recommendations	26
16. Important	27
17. Specifications	28

VORTEX-PEEL

We appreciate your confidence in Silhouet-Tone's products and value your decision to purchase the Vortex-Peel microdermabrasion system.

The Vortex-Peel is a microdermabrasion system used to perform surface skin exfoliation.

The Vortex-Peel microdermabrasion system makes no medical claims. It is intended and should be used by licensed estheticians for esthetic purposes only.

The purpose of this manual is to familiarize the operator with the features, operation and maintenance of the unit.

All rights reserved. No part of this work covered by the copyright hereon may be reproduced or used in any form or by any means – graphic, electronic, or mechanical, including photocopying, recording, taping, or information storage and retrieval systems – without permission of the company.

© 2013

01 .First Use Instructions

It is **IMPORTANT** to follow the instructions below, before using your Vortex-Peel machine for the first time. This procedure will remove any debris that may have become lodged in the pneumatic system during shipping.

1. Remove the machine from the packaging.
2. Unscrew the 4 large screws underneath the machine.
3. Carefully place the machine on its base.
4. Hold the machine in place while someone else secures the unit to the base with the 4 screws removed earlier.
5. Plug the machine into an appropriate wall outlet.
6. Screw the “used crystal” jar container at the back of the unit.
7. Remove the cap covering of the “new crystal” bottle. **DO NOT REMOVE THE PROTECTIVE SEAL.**
8. Place the “new crystal” bottle into the receptacle located on top of the unit, screw tightly in place to pierce the seal.

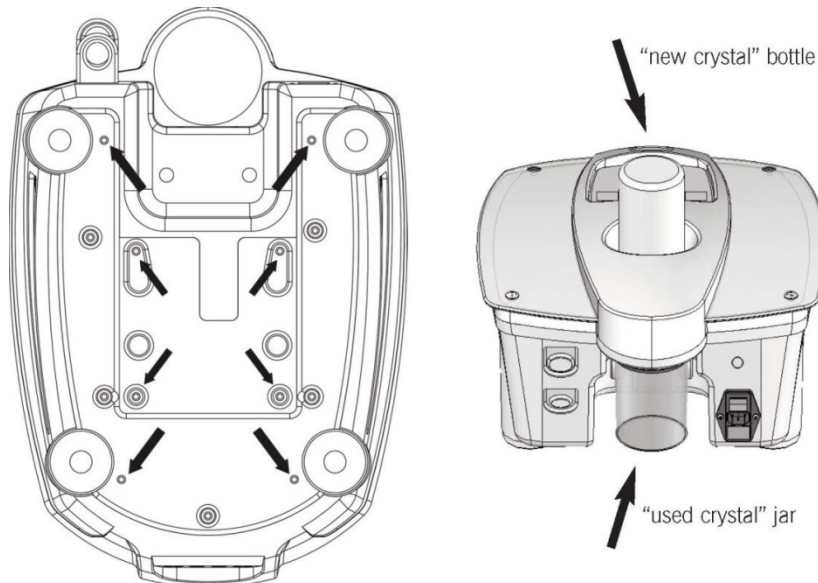

02. Important Safeguards

Read attentively all instructions before using this apparatus.

1. Before connecting or operating this unit, please read this manual carefully.
2. KEEP INSTRUCTIONS. Keep the safety and operating instructions for future reference.
3. HEED ALL WARNINGS on the unit and in the operating instructions.
4. FOLLOW INSTRUCTIONS. Follow all operating instructions and directions of use.
5. CLEANING. Unplug the unit from the wall outlet before cleaning. Do not use liquid or aerosol cleansers. Use a soft makeup brush and a slightly damp cloth to remove powder residue.
6. ATTACHMENTS. Using attachments not recommended by the product manufacturer and is deemed unsafe.
7. POWDER. Do not use corundum crystals other than those recommended by the manufacturer. Improper granulometry can damage the unit's components and create blockages.
8. WATER AND MOISTURE. Do not use the unit near water—for example, near a sink, wash bowl, hydro tub, steamer, wet table, swimming pool, autoclave, hot cabi.
9. BASE SUPPORT. Do not place the unit on an unstable cart, stand, tripod, bracket, or table. A fall could produce serious injury and serious damage to the unit. Use only with recommended base. Follow manufacturer's instructions for unit installation onto base. The combination should be moved carefully. Quick stops, excessive force, and uneven surfaces may cause damages to the unit.
10. TURNING THE UNIT OFF. The handpiece "START / STOP" function on the front of the unit must be turned off before the main switch located at the back of the device is turned off.
11. SLOTS AND OPENINGS in the cabinet are for ventilation. They are there to ensure reliable operation and prevent overheating. These openings must not be blocked or covered. This unit should not be placed in a built-in installation unless proper ventilation is provided for.
12. POWER SOURCE. This unit should be plugged into a properly grounded outlet without the use of extension cords. We recommend the use of a power surge protector.
13. WARNING: This unit is equipped with a three pronged plug. The third prong is the ground. This plug will only fit into a grounded power outlet. This is a safety feature. If you are unable to plug in the unit, have your outlet replaced by a certified electrician. Do not defeat the safety purpose of the grounded plug.
14. POWER CORD PROTECTION. Power supply cords should be routed so that they are less likely to be walked on or pinched by items placed on or against them. Pay particular attention to cords at plugs, convenience receptacles, and the point where they exit the unit.
15. DO NOT OVERLOAD WALL OUTLETS AND EXTENSION CORDS; this can lead to an increase risk of fire or

electric shock.

16. NEVER SPILL LIQUID ON THE UNIT.
17. SERVICING. Do not attempt to service the unit yourself, as opening or removing the cover may expose you to high voltage or other hazards. Refer all servicing to qualified service personnel.
18. DAMAGE REQUIRING SERVICE. Unplug the unit from the wall outlet and refer servicing to qualified service personnel under the following conditions:
 - a. If the power supply cord or plug is damaged.
 - b. If liquid has been spilled or objects have been dropped into the unit.
 - c. If the unit has been exposed to rain or water.
 - d. If the unit does not operate normally when following the operating instructions. Adjust only those controls that are covered by the operating instructions, as improper adjustments of other controls may result in damage and may require extensive repairs by a qualified technician.
 - e. If the unit has been dropped or the cabinet has been damaged.
 - f. If the unit shows a distinct change in performance; this indicates a need for service.
19. REPLACEMENT PARTS. When replacement parts are required, make sure that the service technician uses replacement parts specified by the manufacturer or with the same characteristics as the original parts. Unapproved substitutions may result in fire, electric shock, or other hazards.
20. SAFETY CHECK. After any service or repairs, ask the service technician to perform safety checks to ensure that the unit is in proper working condition.
21. CAUTION: Risk of electrical shock. Do not remove back cover. Refer servicing to qualified service personnel.
22. WARNING: For continued protection against risk of fire, replace fuse only with same type and rating of the one provided with product.

03. Unit Description

3.1 Control Panel

Front view

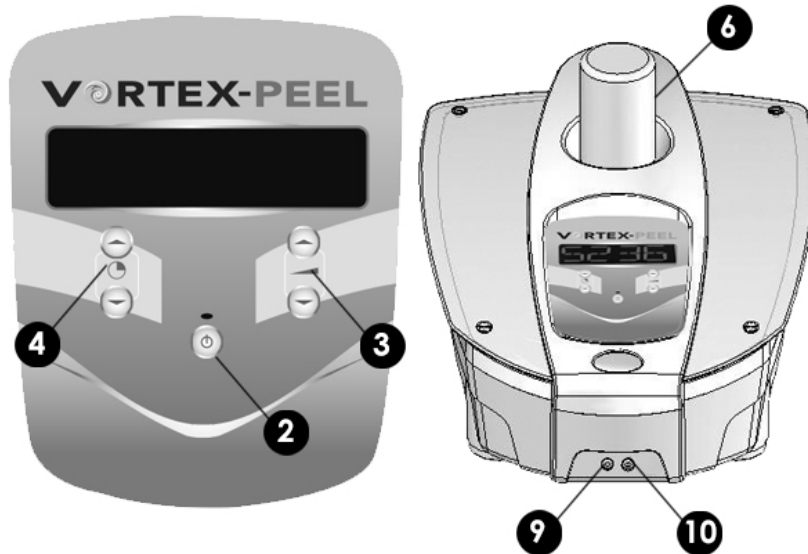

Back view

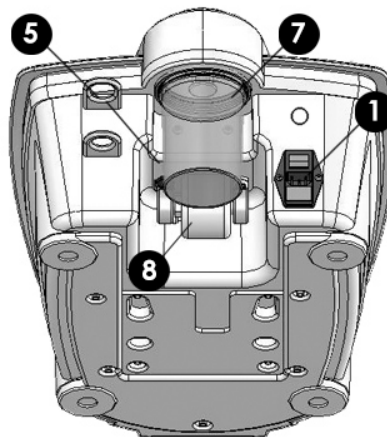

1. Main power switch
2. START / STOP session key
3. Intensity control
4. Timer
5. Handpiece support
6. Clean crystal outlet

7. Container for used crystals
8. Security filter
9. Narrow hose (front panel connector)
10. Large hose (front panel connector)

3.2 Handpiece Installation

WARNING: IMPROPER TUBE CONNECTION WILL BLOCK THE UNIT Connecting the handpiece |

Connecting the plastic tubes

- The narrow hose connects to the front panel's small connector (N° 9) and to the handpiece's small connector.
- The larger hose connects to the front panel's large connector (N° 10) and to the handpiece's large connector.

NOTE: Narrow hose = clean crystals; Larger hose = used crystals. Both hoses must be inserted at least 1 cm (1/2 inch) into their respective connectors.

- Place the handpiece in its support (N° 6).
- Connect the power cord to the back panel of the unit. The wall plug will only fit a three prong grounded power outlet.
- We recommend the use of a power surge bar (available at most hardware stores) to protect the client and the unit against sudden and unexpected power surges.
- Fit the clean crystal container into top outlet (N° 6).
- Nozzle 6. Quick connect fitting

Handpiece

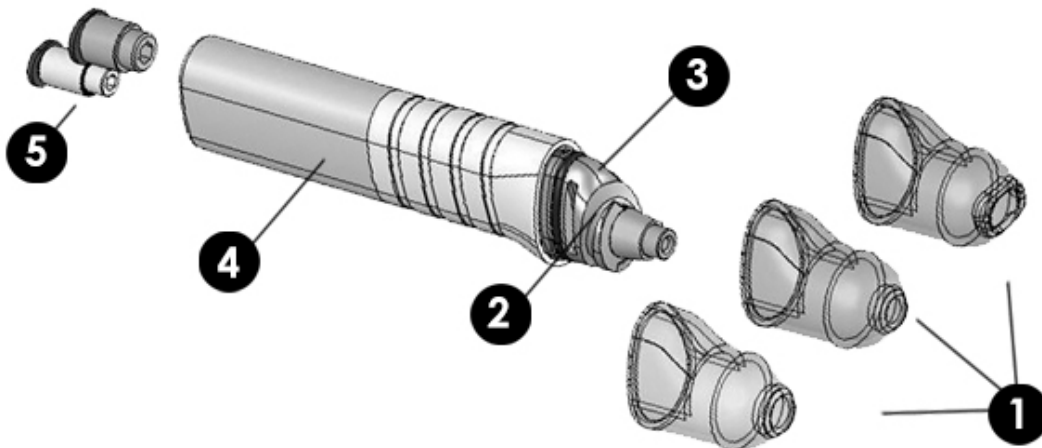

1. Disposable plastic tips
2. O-Ring (ST code 22711562)
3. Spiral head
4. Handpiece body

5. Quick connect fitting

Disposable Plastic Tips

For safe, efficient and sterile sessions, the unit comes with disposable plastic tips. Three sizes are available:

- Small tip: for general facial area.
- Large tip: for body procedures.
- Rectangular tip: for body procedures on scars and stretch marks.

NOTE: The rectangular tip produces an aggressive abrasion and should not be used on the face.

It is very important to clean the handpiece with a dry tissue to remove loose crystals before inserting a new disposable tip. The disposable tip must fit tightly onto the handpiece. Before using a plastic tip, make sure that it is in good condition, that is neither cracked nor damaged, and that it has no sharp edges that can cause injury. The tip may be reused up to 5 times on the same client. Keep tip with client file. Do not give the tip to client. Disinfect the tip to use with alcohol, making sure it is perfectly dry before proceeding with the session.

NOTE: using a damaged tip will result in weak suction. If suction is weak, check the tip and replace, if necessary.

Choose the appropriate disposable plastic tip. Place on the handpiece so that it fits tightly.

3.3 Corundum Crystals

Our certified grade corundum crystals have been thoroughly tested by an independent laboratory for safety and sterility. They have been processed and purified under extremely sanitary conditions. Their only property is to be abrasive. It is not recommended to use crystals other than that supplied with actual equipment. They may damage your equipment and harm the clients.

NOTE: To avoid cross contamination, never use crystals more than once. Used crystals have lost their abrasive properties and they're contaminated.

Corundum crystals are Al_2O_3 pure at 99.24 % and highly uniform granulometry 120 μ (microns).



How to replace the “clean crystal” bottle

To replace empty “clean crystal” bottle:

- ONLY WHEN EMPTY, remove clean crystal bottle, if there is too much crystal left in the receptacle, use the vacuum hose to remove the excess crystals before putting the new bottle in place. Or, disconnect the large hose from the handpiece and use it to vacuum the excess crystals.
- Turn on the unit at 100% intensity, and use the vacuum hose to clean all crystal residues from the clean crystal outlet.
- Remove the cap (DO NOT REMOVE PROTECTIVE SEAL); screw the new "clean crystal" bottle back on.
- If is something entrapped into the small hose, remove both hoses from the handpiece, insert small hose into the large one, turn on the unit at 20% intensity, and leave it running for few minutes. This procedure will remove all crystals trapped in the hoses and prevent blockage.

IMPORTANT

- When using a “new crystal” bottle, always replace the “used crystal” container.
- At the end of each procedure, use alcohol wipes to remove excess powder.
- Never remove the power cable before turning off the unit.
- Always stop the procedure using “START / STOP” key on the front panel before turning off the main power switch.

3.4 Unit Preparation before Microdermabrasion

Before each session, you **MUST** check the following:

- The clean crystal bottle is tightly in place.
- The "used crystal" container has been discarded and replaced with a clean crystal bottle.

NOTE: The unit will not work if this "Used crystal" container is more than 2/3 full.

Before putting container in place, remove any crystal residue from the ridges with a dry tissue and make sure that the container is properly closed.

NOTE: For sanitary reasons and for the safety of your unit, corundum crystals must never be reused.

- Turn on the main power switch on the back of the unit. The LED indicator will light up (Front left of the panel).
- Wait at least 10 seconds for unit to warm up.
- Press the “START / STOP” key (front panel).
- Adjust the abrasion/vacuum power with the intensity key located on the front panel (N° 3).
- The intensity will appear on your screen (strength ranges from 20% to 100%).
- Using the time key, program the procedure time.

3.5 Filters Replacement

The Vortex-Peel unit has 4 filters; two of them require periodical replacement. Debris vacuumed into the “used crystal jar” container reduce efficiency. When suction diminishes, it is time to change the filter*.

* The filters will require less maintenance if the client’s skin is perfectly cleaned and dried prior to each session. We recommend the use of a water based cleansing lotions to avoid clogging problems The skin must be completely free of any moisture; use a hair dryer to complete the drying process. Any moisture left on the skin will create clogging.

How to change the small “used crystal jar” filter (M02 Filter ST Code 416597):

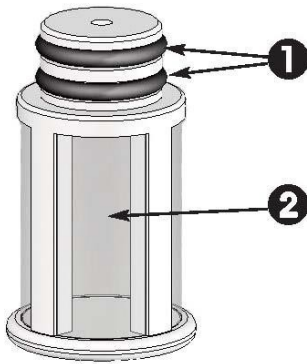

- Unscrew the used crystal jar.
- Pull out the used filter and replace with the new one. Be careful not to damage the filter’s plastic mesh.
- Make sure that the two seals (rubber rings) are on the filter and that the plastic mesh is not perforated. Holding the new filter by the white plastic, push it in with a light twist.

Small “used crystal” filter

1. Rubber ring
2. Plastic mesh (filter)

This small filter is good for approximately 50 procedures.

How to change the external, large safety filter (ST Code 416613):

- The external safety filter located on the back panel will need changing yearly, depending on usage and the type of crystals. The main external filter is to protect your motor against the crystals which. If other crystal products are to be used, they might contain fine powder which will block the filter, reduce the efficiency of your unit and even damage it.
- As this filter is good for 1 (one) year, it is always prudent to keep an extra filter in stock.
- Filter should be changed when projection intensity drastically decreases and lines on filter are no longer visible (sign that filter is filled up with crystals and skin debris).

Instructions

- Press on the two metallic tabs and pull the filter out of the connectors.
- Replace the filter.
- Match the white and black filter’s connectors to the Vortex-Peel’s connectors.
- Push the filter assembly into position (you should hear two clicks).

NOTE: Using Silhouet-Tone corundum crystals will prolong the life of your filter and ensure the proper operation of your unit.

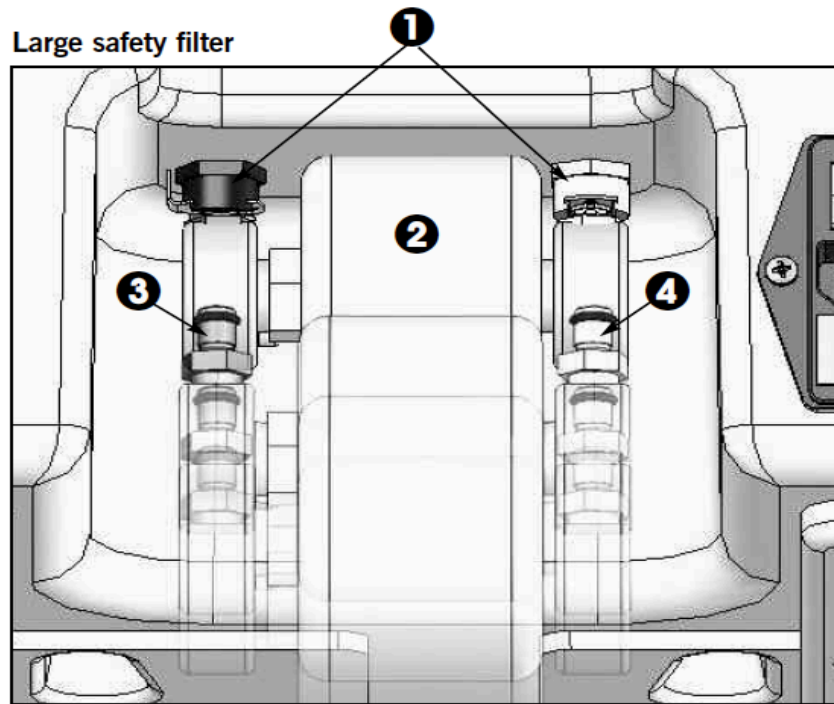

- 1. Metallic Tabs
- 2. Filter

- 3. Black connector
- 4. White connector

04. Microdermabrasion Contraindications

The Vortex-Peel is a microdermabrasion system used to perform surface skin exfoliation.

The Vortex-Peel microdermabrasion system makes no medical claims. It is intended and should be used by licensed estheticians for esthetic purposes only.

Refer client to physician for any medical procedures.

All procedures must be performed on healthy skin, free of infectious or inflammatory conditions. Do not abrade beauty spots, moles or (naevocellular naevi). Bypass them without touching them.

Do not use microdermabrasion on:

- Lesions;
- Dermatitis (eczema, psoriasis, etc.);
- Inflammatory acne or pimples;
- During herpes outbreaks (note: becomes contagious 48 hours before appearance of scab);
- On pigmented solar keratosis;
- People with AIDS;
- People with active diabetes (insulin dependent);
- Users of prescription anticoagulants;
- Sensitive or very reactive skin.

Important recommendations:

- Clients should discontinue use of any irritating products (such as Retin A or AHA's) one week prior to microdermabrasion. Use may resume 3 weeks following microdermabrasion interruption.
- Avoid microdermabrasion before intense sun exposure (ex. sailing, skiing, sun bathing).
- Client should avoid swimming in a chlorinated pool the day of the microdermabrasion.
- People using prescription acne medication isotretinoin (such as Accutane or Noracutane) must wait 6 months before receiving a microdermabrasion procedure.
- Never use Glycolic Acid, Retinol or other low pH products with microdermabrasion procedures

05. Client Record Card

We recommend that you keep a client record card on which you note the client's medical history and medications. Some medications cause hyperpigmentation and will cancel out the effects of microdermabrasion.

It is important to note the following:

- Quality of skin: firm, soft, distended, fine, thick, etc.
- Pigmentation problems: solar keratoses, birthmarks, acne, melasma, etc.
- Other problems: acne, rosacea, sebaceous cysts, wrinkles, enlarged pores, loss of elasticity, etc. When noting wrinkles, specify: superficial or deep.
- Other procedures currently being used by the client, as RF, glycolic acid, laser, etc.
- Scars or stretch marks; note the cause, date of occurrence, size, and depth.
- Skincare products presently used by the client. Skin reaction to each microdermabrasion session should be noted on the client card.

06. Microdermabrasion Series Protocol

Microdermabrasion sessions should be scheduled at 8 to 15 day intervals, depending on client's skin type:

- Oily and thick skin: 8 days;
- Normal skin: 10 days;
- Dry, dehydrated or sensitive skin: 15 days.

A series consists of 6 to 12 microdermabrasion sessions.

After 6 sessions, results should be evaluated and a second series may be suggested.

One procedure per month is recommended to maintain results.

07 . Client Recommendations Prior to Microdermabrasion Session

Prior to a session

- 1 week prior to microdermabrasion, discontinue use of Retin A, AHA's or glycolic acid products.
- 3 months prior to microdermabrasion, discontinue any laser treatments as well as chemical peels including glycolic peels.
- Clients taking oral prescription medication for acne treatments (isoretinoids such as Acutane) should wait 6 months after the end of their acne treatment before undergoing microdermabrasion.
- Postpone microdermabrasion if a client has planned intense sun exposure: sailing, skiing, etc.
- Postpone microdermabrasion in case of dermatitis: infectious acne, eczema, psoriasis, active herpes (cold sore).
- Postpone if skin is cut irritated or sun burned.
- Avoid procedure if you are suffering from severe diabetes or use anticoagulants (prescribed drug) or have tested as HIV-positive.
- Postpone procedure in case of outbreak or if you plan to be exposed to strong sunlight (sailing, skiing).
- Schedule a pre session Skin Analysis Consultation.

08. Room and Client Preparation

Few conditions are recommended for optimum microdermabrasion:

- The aesthetic bed or chair should be at the right height (hydraulic or electric bed). You must place yourself in a position that the handpiece can touch the client's face without pressure and effortlessly.
- The use of a 5 diopter magnifying lamp will allow you to accurately control the level of abrasion and will prevent you from irritating the skin.

The following products must be handy:

- water based cleansing gel;
- hydrating and/or soothing ampoules (vials);
- hydrating and/or soothing cream;
- hydrating and/or soothing mask;
- sunscreen with SPF 15 to 30;
- vinyl gloves (some clients are allergic to latex gloves);
- mask surgical type;
- small gauze or adhesive protective eye shields to place under goggles;
- large gauze to remove crystal residue.

General recommendations:

- It is necessary to protect the client's eyes with self-adhesive eye shields or dry gauze pads covered with protective goggles, secured with elastic around the head.
- Always work on dry (moisture free) skin.
- We recommend the use of a hair dryer, set to a low temperature to dry the skin prior to microdermabrasion session.
- We recommend you the use of protective mask and vinyl surgical gloves while working (some clients are allergic to latex).
- The crystal projection is activated only when an occlusion is created by applying the handpiece on the skin.
- For comfortable and efficient procedures, always pull the skin taut between thumb and fore- finger.

While using the handpiece:

- Never apply pressure on the handpiece; the vacuum does the work, not the handpiece.

Preparing the skin for microdermabrasion:

Skin cleansing

- Thoroughly cleanse the skin: even if the client is not wearing foundation or make-up, there is always an accumulation of dead surface cells and sebum.
- Always use a water based cleansing lotion or gel.
- Rinse thoroughly with water. The use of toner is not necessary.
- Dry skin thoroughly.
- Remove headband since it will be wet following skin cleansing.
- First, dry skin using tissue paper, then with a hair dryer at a low setting, to insure facial hair and peach fuzz is completely dry.

Client setup:

- Use a clean dry headband or bonnet to cover client's ears.
- Protect client's eyes with plastic goggles.

Client preparation:

- Contact lenses must be removed prior to procedure.
- Makeup must be removed. Skin must be completely dried with paper tissue, and / or hair dryer.
- Protect client's eyes with eye shields or eye pads covered with the plastic goggles and cover the ears with bonnet or headband.

IMPORTANT:

Because crystals are highly susceptible to moisture, it is extremely important that the face be thoroughly dry to avoid vacuuming any moisture into the tubes, which can result in clumping of the crystals and blockage of the tubes.

09. Procedure Techniques

Note: To prevent your unit from clogging it is very important to work on skin which is completely dry!

3 basic techniques are used during microdermabrasion:

- The linear sweep is used at the beginning of each session to exfoliate the epidermis. It is also used in a back and forth movement to improve the appearance of minor imperfections.
- The circular sweep is used to improve the appearance of pigmented spots.
- The square pattern sweep is used to improve the appearance of imperfections present in large areas.

Between phases we recommend:

- To remove crystal residue from the skin, using soft gauze.
- To reassess the exfoliation result through a magnifying lamp.

10. Suggested Unit Settings

The Vortex-Peel microdermabrasion system is used to perform surface skin exfoliation.

The depth of exfoliation depends on the intensity of the suction and on the session duration. Power settings vary between from 20 and 100. The digital display allows for 40 levels of intensity.

Intensity Settings:

40 intensity levels: from 20% to 100%, with 2% increments.

- 20% to 30%: eye contour, cheeks and neck area, also for sensitive skin with redness or for fine dehydrated skin. Recommended also for first session (new client).
- 30% to 40%: forehead, nose, chin, coarse areas, or areas with mild imperfections.
- 40% to 50%: very coarse skin, non-sensitive areas and scars.
- 30% to 60%: sensitive areas such as chest or “Décolleté”
- 50% to 100%: non-sensitive areas such as abdominal imperfections.

Upon contact with the skin (occlusion), a small amount of crystals is propelled, providing a slight abrasion. For more powerful abrasion, increase the intensity, taking the client's level of sensitivity and skin type into consideration.

NOTE: To ensure safe procedures, always test the intensity level on the inner portion of the client's forearm before proceeding to the face.

11. Microdermabrasion Procedure Chart

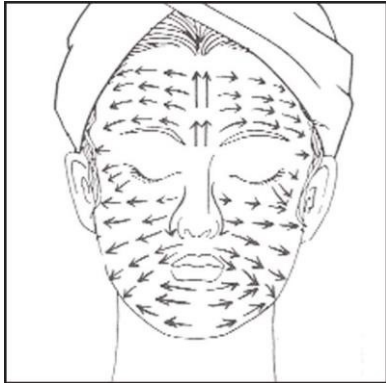

Phase 1

- Linear sweeping”

After completing phase 1, using dry gauze, remove crystal residue from the skin and reassess the depth of the abrasion with the use of a magnifying lamp.

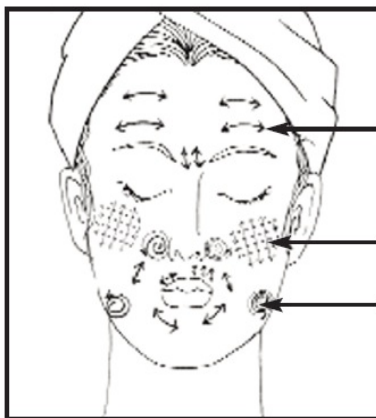

Phase 2

- Circular sweeping or “Eraser like”
- Square pattern sweeping

Regularly remove crystals to reassess the depth of the abrasion for each problem area. Use of a magnifying lamp.

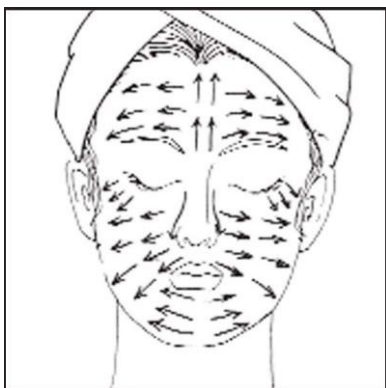

Phase 3

is optional and used to even out microdermabrasion.

Do not perform phase 3 if skin is red.

12. Microdermabrasion Procedure (10-30 min.)

Vortex-Peel microdermabrasion system makes no medical claims. It is intended and should be used by licensed estheticians for esthetic purposes only.

Unlike medical dermabrasion, which involves the complete removal of the epidermis and the partial removal of the dermis (causing bleeding), aesthetic microdermabrasion is a gradual and gentle way of exfoliation (peeling).

The microdermabrasion procedure is divided into three basic phases:

Phase 1- removal of all superficial dead skin cells. Involves the entire face, as per the directions on the face chart, using single linear sweeping motions. Between phases, it is important to remove excess crystals and reassess the skin using a magnifying lamp, before proceeding with the next phase.

Phase 2- deeper microdermabrasion for specific problems. Used on surface imperfections, use a linear sweeping motion (like using an eraser), or a circular sweeping motion (rotation). To cover large areas, use a square pattern sweep.

Phase 3- skin resurfacing. Is optional and should be avoided on sensitive or reactive skin. Use magnifying lamp to assess skin condition. If using phase 3, sweep rapidly the entire face once again using the same technique as in phase 1. The skin must be pink, never red.

After phase 2 or 3:

- Remove any residual crystals from the face.
- Apply a soothing cream to massage the skin. The cream will pick up any remaining residues.
- Using wet gauzes, remove the cream, and rinse thoroughly.
- Apply a soothing moisturizing mask*, leave on for indicated time, remove.
- Spray on a soothing lotion and apply a protective cream with sunscreen.

* Do not use a heat mask. We recommend the use of a cold modeling mask to reduce redness.

Important recommendations

- Always test strength of abrasion on client's forearm.
- Always begin with the forehead, working your way down to the chin and neck.
- Between phases always reassess the exfoliation. Skin should not be red but may have a pinkish tone.

Note: Client may feel a tingling sensation as products are being applied. Skin may feel heat sensation similar to light sunburn.

Session Duration

The duration of a session depends on the skin condition. The number of passes/sweeps will be higher on the body than on the face. The speed at which the sweeps are done also has an effect on intensity of exfoliation.

Session frequency

Each session produces specific results. Depending on the objective, a series of sessions, usually between 1 and 12 is suggested.

Maintenance

- 1 session per month will maintain results obtained from the series of sessions.
- 1 session per month will maintain a youthful appearance.
- 1 session prior to a special evening or occasion will provide an “instant glow”.

The client at home

- The client will see further improvement in the days following a procedure.
- To maximize results, the client should follow a healthy skin care regimen at home:
 - Drink 8 to 12 glasses of water per day.
 - Use hydrating products adapted to skin type.
 - Use a protective cream with sunscreen (SPF 15 to 30).
 - Stay out of the sun for one week following a microdermabrasion session.
 - Wait 3 weeks following a procedure before resuming use of Retin A, AHA's, glycolic acid or essential oil products.
 - Must avoid low pH products. All products applied after microdermabrasion must have a pH balance between 4.5 and 7.0.
- 48 hours after procedure:
 - Apply hydrating products regularly and as often as necessary.
 - A slight redness is to be expected, there may be some skin flaking during the third and fourth day. This is exfoliated skin.
 - Avoid saunas, swimming pools and whirlpools.
 - Avoid all sun exposure and tanning salons.
 - Always use sunscreen.
- One week after procedure:
 - Avoid all sun exposure and tanning salons.
 - Continue using moisturizer and sunscreen
- Three weeks after procedure:
 - Client may resume use of her regular cosmetic products such as Retin A, AHA's, glycolic acid or essential oils.

13. Combining Microdermabrasion with Facial Procedures

The Vortex-Peel is a microdermabrasion system used to perform superficial skin exfoliation.

Microdermabrasion should be added to increase the effects of other facial procedures. When performed before the application of cosmetic ingredients, microdermabrasion will dramatically increase and accelerate results. With exfoliation, cosmetic ingredients work at their full capacity.

NOTE: It is important to check the pH of cosmetic products. Low pH (acidic products) may cause an irritation. Products between pH 4.5 and 7.0 (with neutral pH) will be better tolerated.

Preparing the skin prior to a facial procedure:

- Cleanse the skin with an oil free cleanser.
- Dry the skin completely using hair dryer.
- Use microdermabrasion – Sensitive skin: Phase 1 only; Coarse skin: Phase 1 & 2 only.
- Do not use steamer after microdermabrasion, heat may cause irritation.
- Extract blackheads and comedones.
- Disinfect the skin.
- Apply cosmetic preparations (must be pH balanced).
- Perform a manual massage.
- Apply a hydrating mask.
- Apply soothing protective cream. Avoid using oil based or comedogenic products on oily skin, they might cause outbreaks.

WARNING:

DO NOT USE CHEMICAL PEELS OR ANY PRODUCTS CONTAINING AHA'S, BHA, TCA OR GLYCOLIC ACID AND MODIFIED JESSNER'S, IN COMBINATION WITH MICRODERMABRASION.

THESE PEELS CAN CAUSE EXTREME DISCOMFORT, OOZING AND SCABBING AND INDUCE PIGMENTATION.

14. Other Applications of Microdermabrasion

Hand Procedure

Intensity: 20 to 50 (according to thickness of skin)

Make sure hands are free of any oily substances and dry. Hand procedures (exfoliation) can be added to manicure procedures, before the hand massage. Use a square pattern sweep all over the hands and circular sweeping on pigmented areas.

- Use a skin lightener to improve the appearance of pigmentation, immediately post procedure and for home care.

Body Imperfection Procedure

Intensity: 50 to 100 (according to sensitivity)

- The area must be clean and dry.
- Use the large rectangular tip.
- Use a sweeping pattern to cover the area to be treated.
- Use a back and forth sweeping pattern.
- Apply a stretch mark, scar or firming cream.

Important recommendations:

- The intensity levels are “suggested settings”. It is recommended to always work with low settings and do a “patch test” to determine the suitable level of exfoliation.
- Always take the client’s level of sensitivity and skin type into consideration.
- Between phases always reassess the exfoliation. Skin should not be red but may have a pinkish tone.

15. General Client Recommendations

Immediately after peel:

- Moisturizer and sunscreen will be applied before leaving facility.
- Moisturize and reapply sunscreen several times throughout the day, as needed.
- Your skin will feel like as though you have a mild wind burn or sunburn. Maintain hydration, both topically and internally (drink plenty of water).
- Avoid direct sunlight, sun tanning, sun beds, and waxing the treated areas for at least 1 week following procedure.
- Avoid swimming in a chlorinated pool the day of the procedure.

After peel

- Maintain hydration of skin and increase fluid intake.
- Continue to use sunscreen at least SPF of 15. We recommend no more than SPF 35.
- Avoid retinoic acids and glycolic for three (3) weeks.
- When an initial series of sessions is selected, schedule your next procedure between one (1) week to fifteen (15) days, and for maintenance sessions, schedule your next procedure between four (4) to five (5) weeks, to maintain results obtained by the procedure.

Sun exposure:

- Exposure to UV rays from the sun or tanning bed must be avoided during the 7 days.
- Skin prone to hyperpigmentation must be extra careful and use sun block at all times.
- The use of a sunscreen above SPF35 is not recommended because of its high chemical concentration, which can provoke skin irritation.

Desquamation:

- During the 3rd and 4th day following the microdermabrasion, skin may peel.

Swelling and redness:

- May be due to aggressive or low pH acid products used after the microdermabrasion.
- An allergic reaction to a product will cause an intense heat sensation during product application. You must remove the product at once and use a cooling mask.
- Products containing Retin-A, AHA's, enzymes or essential oils may also cause skin irritation when used after the procedure. Skin will therefore be over treated and may react causing swelling or redness.
- Following procedure some skin types may also show slight swelling, this is not a problem. Apply calming and hydrating products.

16. Important

This apparatus must be operated by a qualified/certified person with knowledge of microdermabrasion. Inappropriate use of the unit or failure to maintain the unit properly absolves Silhouet-Tone and its representatives from any responsibility whatsoever in the case of damage, injury, or malfunction. The warranty is void if the unit is not used according to the conditions mentioned in this manual.

Refer to Service Manual for troubleshooting.

Accessories		
416613	External large safety Filter	1
416622	Flexible Tubing (6/4)	1
22711562	Hand piece O-Ring (#16)	4
411485	Hand Piece	2
416643	Eyelid Protector	3
421340	Instructions Manual Vortex Peel	1
Supply Cable		
23911253	Supply Cable (110V)	1
23912019	7A SB Fusible (110V)	2

17. Specifications

Power supply:	110v 240v / 50 Hz 60Hz
Vacuum power:	Min. 15 in (380 mm hg) 0, 51 BAR Max. 26 in (660 mm hg) 0, 88 BAR
Air flow:	Max. 4,8 m ³ (2,8 cm)
Dimensions:	Width: 14.6 in (37.1 cm) Height: 9 in (22.9 cm)
Apparatus & base weight:	Depth: 21.3 in (54 cm) 30.5 lbs (13.84 kg)
Materials:	Steel & aluminum with plastic casing
Electronic:	Microprocessor controlled
Temperature ambient:	+10 to 35 C
Permitted relative humidity:	30 to 65 %

SILHOUET -TONE RESERVES THE RIGHT TO CHANGE THE SPECIFICATIONS OF THE APPARATUS WITHOUT NOTICE.

All rights reserved. No part of this work covered by the copyright hereon may be reproduced or used in any form or by any means – graphic, electronic, or mechanical, including photocopying, recording, taping, or information storage and retrieval systems – without permission of the company Silhouet- Tone Corporation.

© Silhouet-Tone Corporation 2013



SILHOUET-TONE®

SILHOUET-TONE CORPORATION

2185, Michelin
Laval (Quebec) H7L 5B8 Canada
Tel. : 450 687-9456, 1 866 340-9456
Fax: : 450 687-5155
export@silhouettone.com

SILHOUET-TONE (CANADA)

1985, Monterey
Laval (Quebec) H7L 3T6 Canada
Tel.: 450 688-0123, 1 800 361-3004
Fax : 450 688-0803
info@silhouettone.com

SILHOUET-TONE (U.S.A.) INC

1623 NW 84th Avenue
Miami, Florida 33126 U.S.A.
Tel.: 1 800 552-0418
stusa@silhouettone.com

SILHOUET-TONE (EUROPE) S.A.

9, route Suisse, CH-1295-Mies, Suisse
Tel.: +41 22 775-15 60
Fax.: +41 22 775-15 67
ste@silhouet-tone.com

SILHOUET-TONE FRANCE Sarl

14, avenue du Dr Palluel
74160 St-Julien-en-Genevois, France
Tel.: +33 4 50 49 45 32
Fax.: +41 22 775-15 67
stf@silhouet-tone.com

www.silhouettone.us



* Sites: Tolhurst, Monterey, Michelin.