

Breath Pedi-Lounge



TOP: Comes with two foot cushions and head cushion (not shown). Shown w/ Pedicure Bowl (sold separately)

Top design Unique, non-motorized, rocking design gently moves and soothes
Ergonomically shaped to help release stress
Adjustable head and dual-foot cushions are included
Split cushions remove to reveal opening for pedicure-bowl access
Fabric safety strap prevents over-rocking

Materials UltraSoft-Touch PU vinyl in Camel color, fabric-backed, PVC-free
Foam 1-1/2" foam beneath vinyl cover

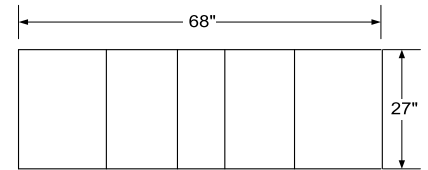

BASE & FRAME:

Materials Solid Rubberwood
Finish Wenge finish (dark wood)
Capacity Static weight capacity 450 lbs. Suitable for persons up to 6' 4" in height
Locks Adjustable locking mechanism holds Lounge in any position
Pedicure Bowl Access Easy pedicure-bowl access by removing either (or both) foot pads
Accommodates up to 18.5" diameter bowl (not included)

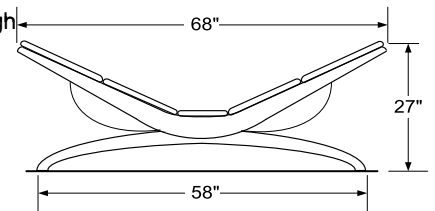

GUARANTEES:

Structure 1 yr. on frame/structure
Fabric & foam Guaranteed to arrive in good condition

WEIGHTS:

Lounge weight 73 lbs.
Shipping weight - boxed 126 lbs. (73" x 28" x 21")

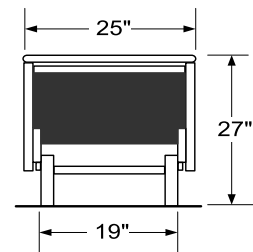

Rev 8/11

www.TouchAmerica.com
(800) 678-6824 · (919) 732-6968
PO Box 1304 · Hillsborough · NC

TouchAmerica
evolving the spa experience