



PORTABLE NAIL FILING SYSTEM

MODEL 10 IP-DXR (Rose Gold)
& IP-DXU (Unicorn)



USER MANUAL



www.ikonna.com

PACKING LIST

1. Model X Portable Drill x 1
2. AC Adapter (DC24V 1A) x 1
3. Instruction x 1
4. Warranty Card x 1
5. Drill Bit x 1
6. Handpiece Seat x 1
7. Handpiece Holder x 1

FUNCTIONAL DESCRIPTIONS

- LCD screen
- Switch and Speed Controller
- Three-cores Socket
- Forward and Reverse Switch
- Battery and Charging Indicator
- DC Socket
- Abnormal Indicator
- F/R Indicator
- Speed Indicator
- Handpiece



INTRODUCTION

Thank you for choosing our next generation nail drill! This electric nail polishing machine contains a drill bit and one main engine. This engine controls the power supply and adjusts the drilling speed, which is necessary for performing professional manicures, pedicures, acrylic nails, and removing gel nail polish. The drill's light weight and compact design makes it a must-have nail drill for professional use. Please take a moment to carefully read the important details about your drill in this instruction manual.

OPERATION INSTRUCTIONS

1. Rotate the spindle to the left, choose one drill bit, and push the bit into the hole at the tip. Rotate the spindle to the right to fasten the bit.
2. Connect the nail drill to the handpiece. Then plug the charger into the base of the nail drill.
3. When the switch is on, there will be a second of startup time, and then the motor will begin turning. Note the location of the Battery and Charging Indicator on the LCD Screen. A full charging takes about 2 hours.
4. Rotate the Speed Controller knob clockwise to turn on. It will turn on when you hear the sound of a "click." Rotating the Speed Controller knob adjusts the speed of the drill. Turn it clockwise to accelerate and counterclockwise to decelerate.
5. To change the rotation direction of the drill bit, use the Forward and Reverse Switch located next to the Speed Controller knob.
6. When finished using the drill, rotate the spindle and remove the drill bit.

Note: When fully charged, the drill will operate for around 10 hours.

FEATURES

1. High-powered, portable, and small space-saving size.
2. Light-weight, compact design perfect for traveling.
3. Ideal for professional salons or home use.
4. Designed with 1 drill bit and 35,000 RPM rotation speed.
5. Easy to operate and specialized for carving, engraving, grinding, sharpening, sanding, polishing, drilling, etc.

SPECIFICATIONS

- Adapter Input Voltage Range: AC100-240V/50-60Hz
- Adapter Output Voltage: DC24V 1A
- Charging Time: About 2 hours
- Speed: MAX 35,000 RPM
- Battery capacity: 2000mA (11.1V)
- Battery life at full speed: About 10 hours.

PRECAUTIONS FOR BATTERY USE

1. If the battery is detached, please install it gently. Rough handling could cause the battery to leak, overheat, or explode and cause a fire. If the battery is not detached and is already installed, do not remove it. Removal can cause damage and safety hazards.
2. Please do not weld the battery terminal. Do not let the battery contact other metals such as jewelry. Do not store the battery in the electrically conductive case. Do not allow the battery terminal to contact any conductive surfaces. Doing so could result in equipment damage, bodily injury, or battery explosion.
3. Please do not squeeze the battery and do not use the needle to pierce the battery. This could cause the battery to leak, overheat, or explode and cause a fire.
4. Battery fluid is caustic. If it contacts your skin or clothes, it could burn your skin. Quickly wash the wound with soap and water and seek medical help.
5. Please do not use the battery if it is overheating, changing color, deformed, bulging, or leaking during the charging, use or storage.
6. If battery liquid gets in your eyes, it could cause blindness. If this happens, do not rub your eyes! Thoroughly flush your eyes with clean water and seek medical help immediately.
7. Please do not attempt to remove or replace the battery. This could cause the battery to leak, overheat, or explode and cause a fire.
8. Please do not use or store the battery anywhere near open flames or heaters. This could cause the battery to leak, overheat, or explode and cause a fire.
9. If the battery is leaking or smells odd, please take the battery far away from any open flames or heat sources, otherwise it could leak, overheat, or explode and cause a fire.
10. Please keep the battery dry or it could leak, overheat, or explode and cause a fire.
11. Please use and store the battery in a location shielded from direct sunlight, otherwise it could leak and overheat, which results in poor performance and shorter life-span. Please keep the battery in a cool and shady place.
12. Please do not use the battery in a high-pressure environment. Do not touch the battery with the electrical supply. Doing so can cause a short circuit or explosion.
13. The battery can be recharged more than several hundred times, but it does have a life-span. When its life has reduced to 50% life-span, we suggest you replace it with a new battery.
14. Do not throw the battery into a fire, which could cause it to explode. Do not discard the battery into the garbage. Please take the battery to a place facility where spent batteries can be properly handled.

ATTENTION: CONSECUTIVE CHARGING TIME MUST NEVER EXCEED 12 HOURS

1. By following the instructions below, you can save the battery's power and lengthen its life-span.
2. Do not charge the battery in a place that is excessively hot or excessively cold as this will cause poor performance and shorten its life-span.
3. Please turn the drill off when not in use.

SAFETY RULES

1. Never unplug the power supply when the motor is still running.
2. Always unplug the drill from the electrical outlet when not in use.
3. Do not attempt to repair the appliance. For repair service, please contact the agent or authorized repair center directly for fast, high-quality service.

PRODUCT INCLUDED

1 x Electric Nail Drill
1 x Handpiece seat
1 x AC Adapter
1 x Handpiece holder
1 x Drill Bit
1 x Instructions

PRECAUTION

To avoid the risk fire, electrocution, and injury, please read and follow all warnings and cautions described below before operating the drill.



WARNING

This symbol indicates the possibility of being seriously wounded or killed if the product is operated incorrectly or contrary to these instructions.



CAUTION

This symbol indicates the possibility of being seriously wounded or killed if the product is operated incorrectly or contrary to these instructions.

- Please keep these instructions nearby to people who will use the product.
- Please give these instruction to anyone who will be using the product.



WARNING

- Please use only the AC adapter provided.
- Never use any AC adapter other than the AC adapter provided.
- Please charge the battery properly.
- Please only use the AC adapter with the rated indication controller.
- Please do not use any DC power supply or engine generator with this controller.
- Please do not charge in temperatures under 0 degrees or over 40 degrees Celsius.
- Please charge in a well-ventilated location.
- When charging the controller, please do not cover it with anything.
- When finished charging the controller, please remove the DC connection plug of the AC adapter from the controller.
- Please be careful to avoid electric shock.
- Do not touch the plug with wet hands.
- Please be mindful of the location where the product is used.
- Please do not use the AC adapter and battery controller in excessively humid or wet places, and never outdoors in the rain.
- Your workstation must have adequate lighting.
- Please do not charge anywhere near flammable liquids or gas.
- PLEASE USE SAFETY PROTECTION GLASSES.
- Please use safety protection glasses while working. Please use a protective face mask to avoid inhaling dust.

- Please avoid inadvertently starting the product.
- Do not push the switch when not using the product.
- The switch must be turned off when connecting the product to a power supply.
- Do not put the charging controller in or near any open flames.
- Do not use the charging controller when the operation time is extremely short.
- Please turn off the switch when the battery is drained.
- There is a possibility the product affects pacemakers.



CAUTION

- Please work in clean, well-ordered environment with adequate room.
- A cluttered, disorganized place could cause problems.
- Please keep the product away from children.
- Please do not touch the charging controller or AC adapter cord except as needed while working.
- Please store the product neatly when not in use.
- Please keep in a place inaccessible to children or that can be locked.
- Please do not keep rechargeable controller in a place where the temperature could exceed 50° such as in a metal box or car in that can reach high temperatures in the sun.
- Please keep in a dry place.
- Please do not use the device carelessly.
- For safe, efficient work, please adjust the speed which is most efficient for the device and task at hand.
- Do not lock the handpiece while it is moving.
- Never use the device for anything other than its intended purpose.
- Please wear suitable clothing when using the device.
- Please avoid wearing knitted gloves or clothing with open cuffs. Long hair is in danger of being caught in the device.
- Please handle the controller and AC adapter with care.
- Please handle the AC adapter carefully. If any part of the device is broken, please contact the shop where you purchased and ask for repair services.
- Please keep the handpiece dry and away from oil and grease.
- Please do not use the device roughly.
- Always be gentle when connecting or disconnecting the plug. Do not carry the device by its cord.
- Please keep adequate distance between the cord and any flammable or explosive materials.
- Please do not damage the AC cord or motor-unit cord to prevent electric shock or fire.
- Please do not attempt to dismantle or adjust the appliance yourself.
- Please work in a clean space with adequate room and use the device in an uncluttered, well-organized area.
- Please do not use the device when you are tired.
- Please inspect the device for damage or broken parts before use.
- Please check the device to see whether or not there is any damage. Test the device to ensure it is working normally.
- Please check the place where influenced its performance.
- Please do not use the AC plug or AC adapter if either is broken. If either has been dropped and/or damaged, please do not use them.
- Please do not use if the battery controller does not turn on or turn off by the switch.
- If anything seems unusual about the battery controller, do not use it.
- Contact to your supplier. If you need repair services, please bring the device to your supplier.

- Please do not attempt to open, repair or modify the controller in any way. Only qualified service technicians should perform such actions.
- If the controller is overheating or seems abnormal in any way, please contact your local supplier for inspection and repair.
- Please never attempt repairs yourself. It could cause accident and injury. Please contact your local supplier for inspection and repair.
- If operating time is too short, even after proper charging, the battery's life-span is expired. Please contact your local supplier to install a new battery.



CAUTION of Lithium-ion polymer battery

The lithium-ion polymer battery is an expendable item with a life-span.

- There are protection features to optimize the Lithium-ion polymer battery's life-span by stopping the motor. When the handpiece stops for one of the reasons below, it is not a malfunction:
- When the battery level is very low, the handpiece will stop. In this case, you simply need to recharge the battery.
- If sudden high pressure is applied to the handpiece, it will stop. In this case, please turn off the switch, drop the speed level to Min, then turn on the switch again.



WARNING

- Please follow the below instruction to avoid battery fluid leakage, overheating, smoke, or explosion of the Lithium-ion polymer battery.
- Do not damage the battery controller by dropping it, hitting it, stepping on it, throwing it, or handling it roughly. Please avoid any high impacts.
- Please do not use any AC adapter except the one provided with the battery controller.
- Please use the battery controller by following all instructions.
- Please stop charging if the battery level remains low after charging.
- Please do not put the battery controller in a microwave or any high pressure container.
- Please do not apply high pressure or heat to the battery controller.
- Please keep away from any combustible materials if the battery controller is leaking or smells odd.
- Please avoid using where there is static electricity.
- Please stop using the battery controller if it has changed color, is hot, or has changed shape.
- Please do not use the battery controller if anything seems unusual.



CAUTION

- If you get battery fluid in your eyes, please flush your eyes thoroughly with clean water well and immediately go to the nearest hospital. Please do not wipe or rub your eyes.
- If battery fluid touches your skin or clothes, quickly wash with soap and water.
- Please return the device before use if there is any smell or high temperature when you first unpack the device.

PART NAMES

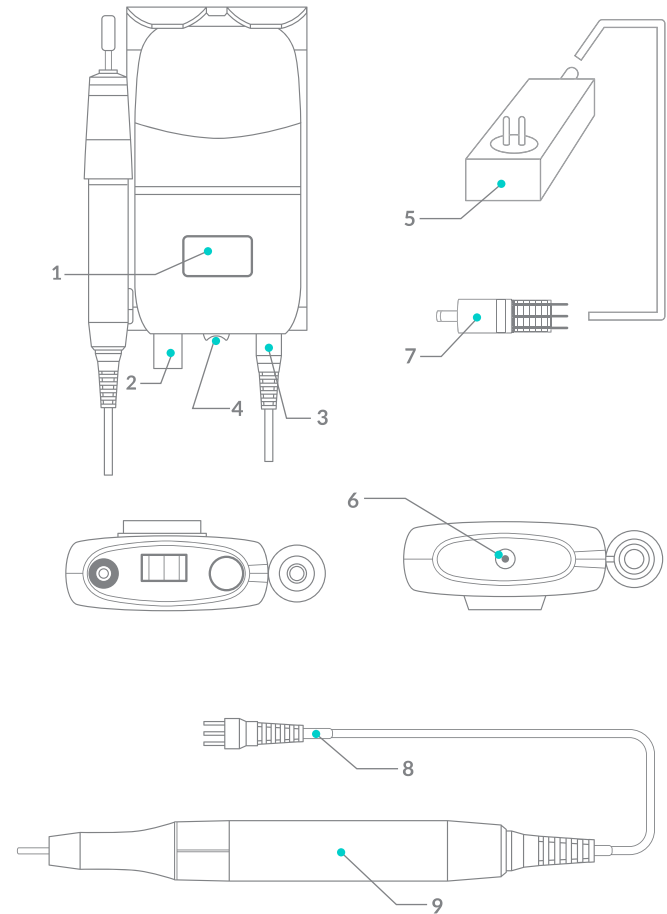

- | | |
|--------------------------------|--------------------------|
| 1. LCD screen | 6. DC socket |
| 2. Switch and speed controller | 7. DC connector |
| 3. Three-cores socket | 8. Three-cores connector |
| 4. Forward and Reverse | 9. Handpiece |
| 5. Adapter | |