

Circline Illuminated Magnifiers MC-Series

Light and Magnification Combine for Comfortable Viewing of Small Details

Lens:

- 5-inch diameter
- Crown optical glass
- Crystal clear
- Distortion free

Light Source:

- 22-watt Circline fluorescent
- Multiple color temperature bulbs available
- Even, shadow-free light for optimum brightness and accuracy
- Protective bulb shield standard

IV-Pivot interchanges with clamp, pedestal or caster floor stand. Weighted desk base models also available.

7100-093 Standard dual-clamp has two heavy duty studs that prevents the base from moving and twisting off horizontal surfaces. Robust, all metal construction, unsurpassed in task lighting market.

Interlocking arm channels for extra strength.

Finish:

- Powder coated
- Maximum durability
- Environmentally safe

Floating Arm:

- All-metal channels
- Sleek design
- No exposed springs
- Hygenic
- Easy to move
- Stays in position

Precision, counterbalanced spring for years of failure-free use.

Optional: Adjustable clamp-on base can mount on any vertical, horizontal or slanted surface. It can clamp onto the right, left, top or back side of a tilted tabletop (7100-08).

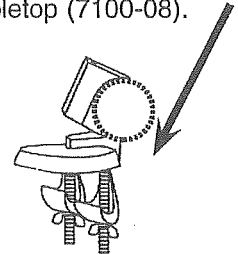

Stylish MC-series magnifiers cast an even glow on your task for optimum brightness and accuracy. These magnifiers reduce eyestrain and fatigue by combining the two key factors in aiding our vision — **Light and Magnification.**

Available Lenses:

- 3-diopter (+75% magnification)
- 5-diopter (+125% magnification)
- 11-diopter (+275% magnification)
- 16-diopter (+400% magnification)



DAZOR MANUFACTURING CORP.

2079 Congressional
St. Louis, MO 63146

800-345-9103 ~ 314-652-2400 ~ 314-652-2069 Fax
www.dazor.com ~ info@dazor.com

INSTRUCTIONS FOR ASSEMBLING CIRCLINE TUBE IN DAZOR MAGNIFIER

1. Note the position of the clamp finger (B) directed up and out over the tube.
2. Remove thumbscrews (A) and clamp fingers (B).
3. *Position circline fluorescent tube (C) with lamp pins facing the socket. Be sure to have the FLAT side of the socket on TOP and facing you while installing the bulb.
4. Connect the bulb to the socket.
5. Replace the thumbscrews (A).

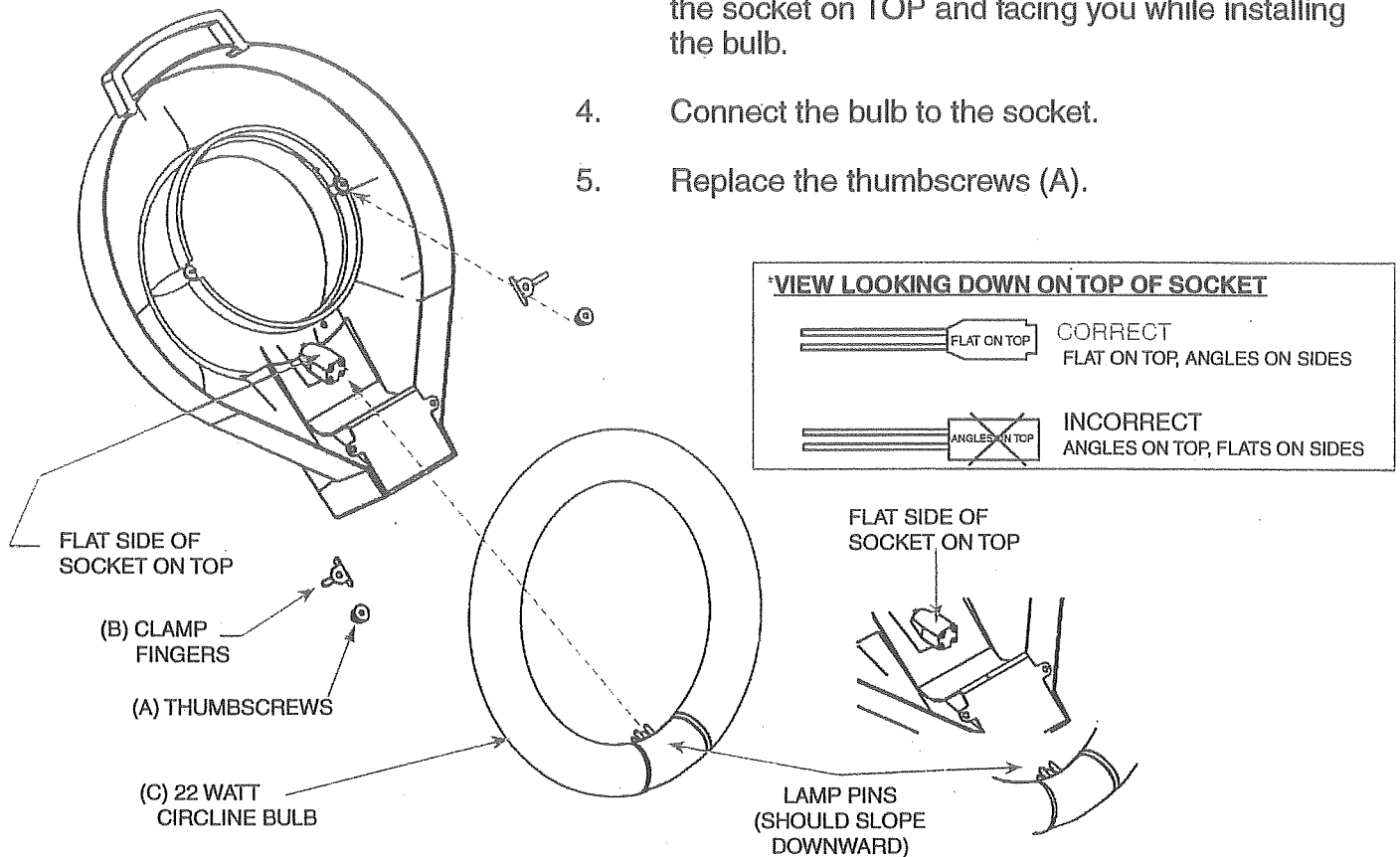

ADD-A-LENS

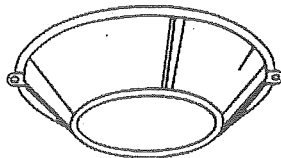

INSTRUCTIONS FOR ASSEMBLING

1. Remove thumbscrews (A) but leave clamp fingers (B) in position.
2. Position ADD-A-LENS over clamp fingers (B) and replace thumbscrews (A).

DAZOR ADD-A-LENS® (optional accessory) ADD-A-LENS #1400

The 8-diopter ADD-A-LENS accessory increases magnification of a 3-diopter lens from +75% to +275% (11-diopter).



DAZOR MANUFACTURING CORP.
2079 Congressional
St. Louis, MO 63146

800-345-9103 ~ 314-652-2400 ~ 314-652-2069 Fax
www.dazor.com ~ info@dazor.com

Form 8FM100-12